

INSTRUÇÃO DE MONTAGEM



ECO-CENTER 3-4 reservatórios

GIVI MOBILI ACESSÓRIOS PARA MÓVEIS LTDA.

Rua João Bettega, 4.800, Módulo V - CEP 81350-000 - CIC - Curitiba - PR

Fone: (41) 3906-8080 FAX: (41) 3906-8008

www.givimobili.com.br

LIXEIRA SELETIVA EXTRAÍVEL



- Sistema ambidestro;
- Para módulo de 500mm;
- **Não aconselhável para portas de alumínio.**

Composições

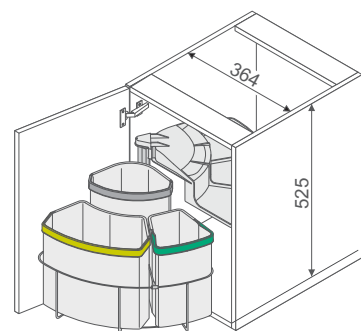

ECO-CENTER
3 cestos

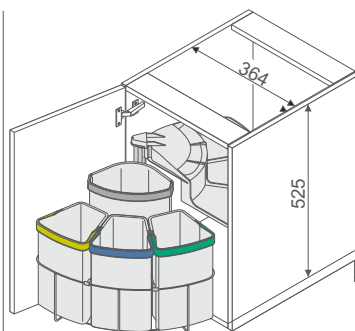

ECO-CENTER
4 cestos

Composição

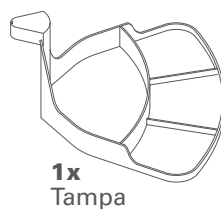

1x
Tampa

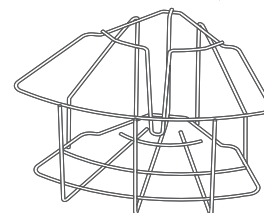

1x
Cesto
aramado

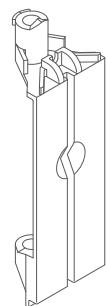

1x
Suporte
do cesto

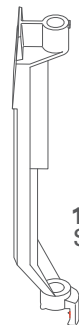

1x
Suporte da
tampa

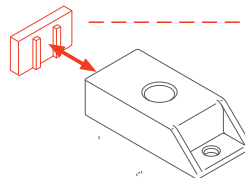

1x
Prolongador

1x
Guia de rotação

1x
Haste



1x
Guia
da haste

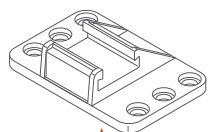

1x
Suporte da
haste

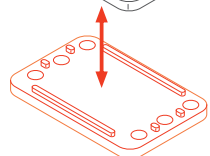

1x
Prolongador

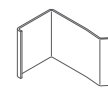

1x
Mola
especial



Utilizar prolongador somente quando necessário.



1x
Guia do
cesto



2x
Separador

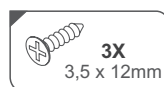

3X
3,5 x 12mm

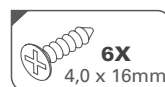

6X
4,0 x 16mm

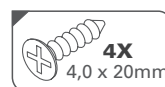

4X
4,0 x 20mm

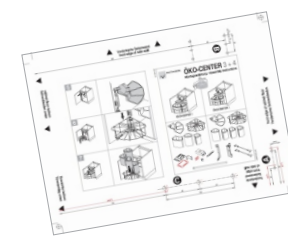

1x
Gabarito para furações



1x
Instrução de montagem

Opções de cestos

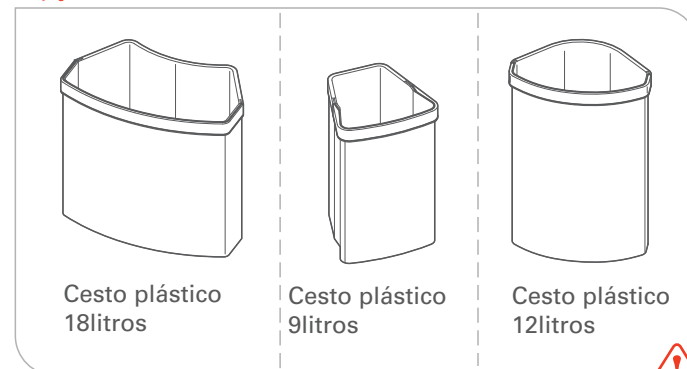

Cesto plástico
18litros

Cesto plástico
9litros

Cesto plástico
12litros



ATENÇÃO

1 Gabarito

O sistema vem acompanhado de gabarito, facilitando a marcação das furações no móvel.



ATENÇÃO

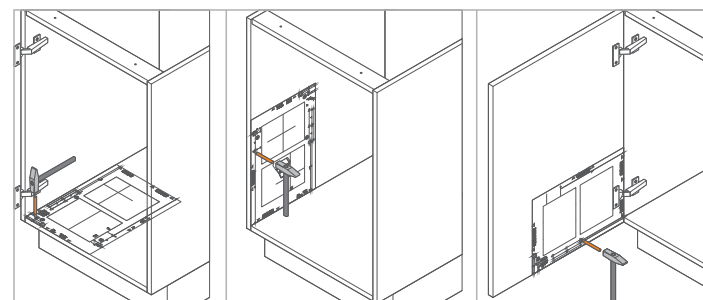

1 Marcação
na base

2 Marcação
na lateral

3 Marcação
na porta

2 Fixação guia de rotação

ATENÇÃO Fixar após a utilização do gabarito

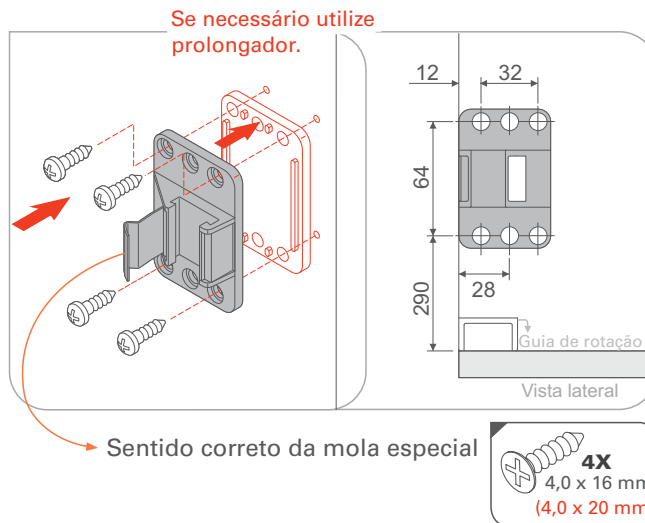
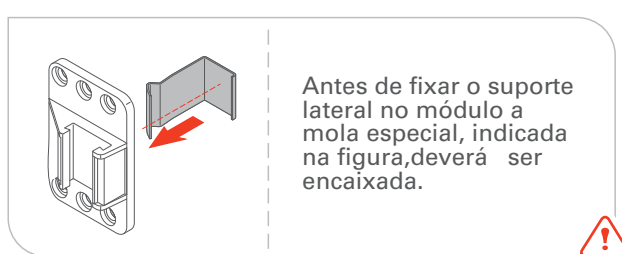
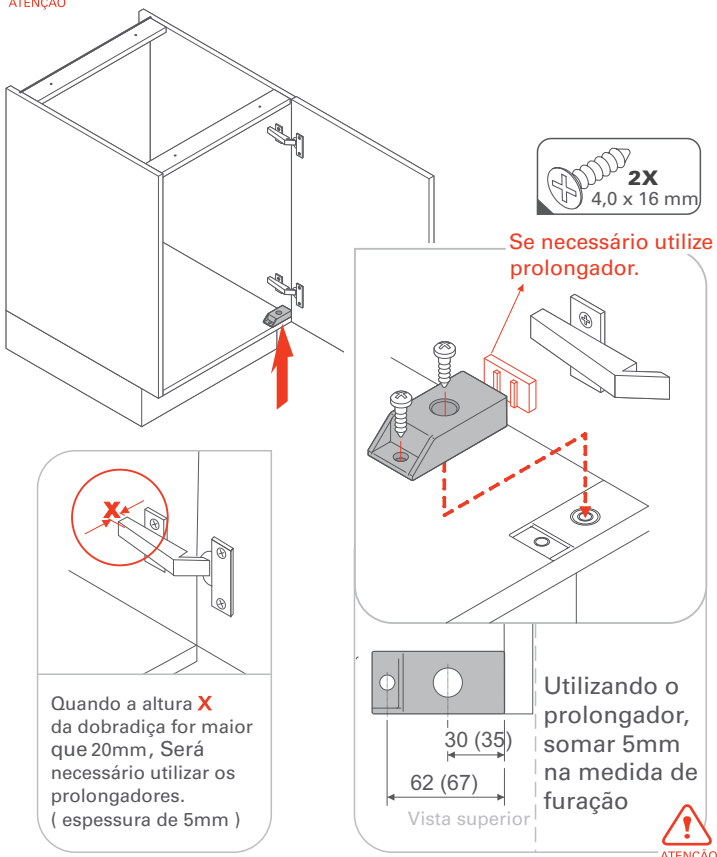

4 Montagem da guia do cesto

ATENÇÃO Fixar após a utilização do gabarito

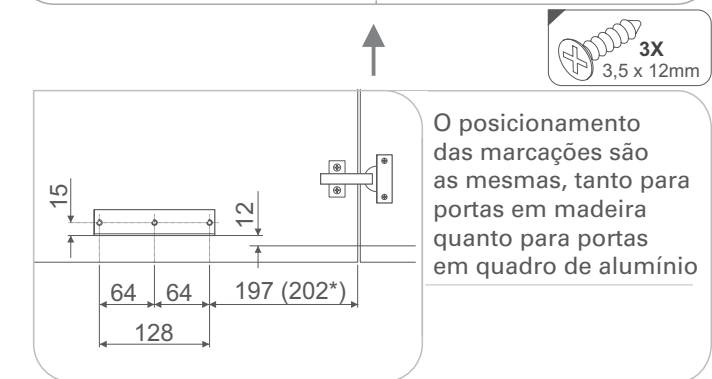
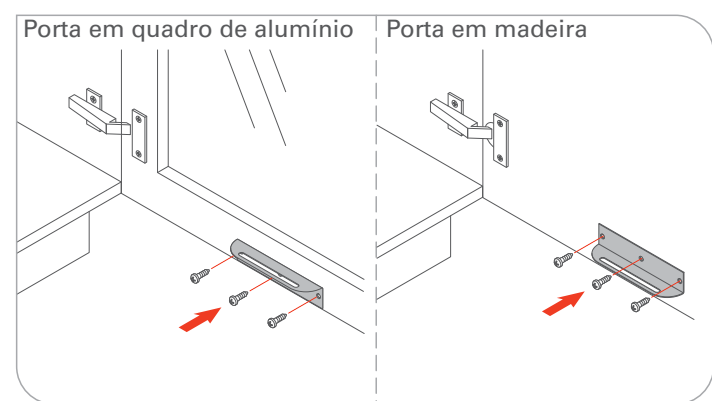
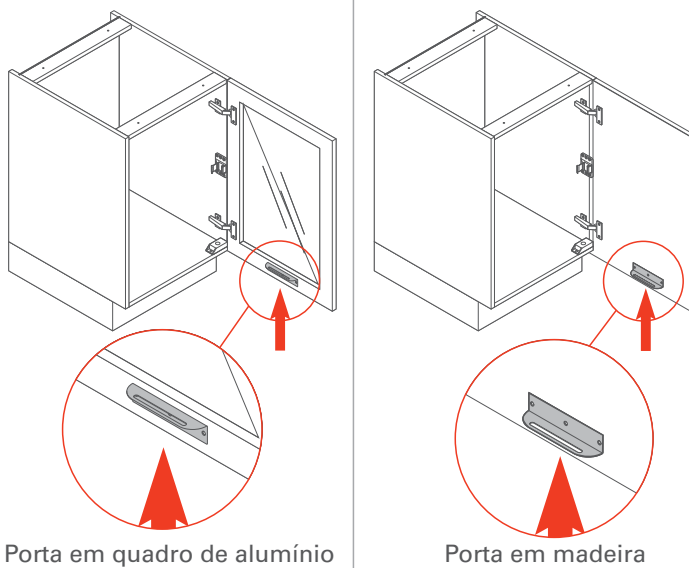

5 Montagem da haste com suportes

3 Fixação suporte da haste

ATENÇÃO Fixar após a utilização do gabarito

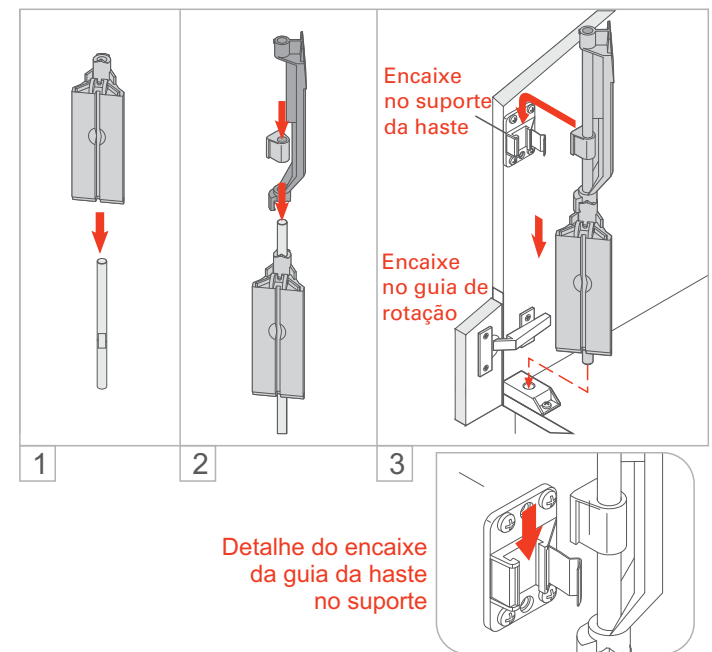
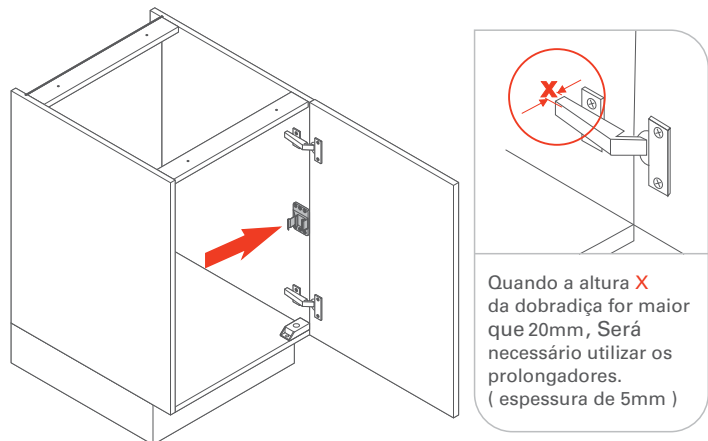

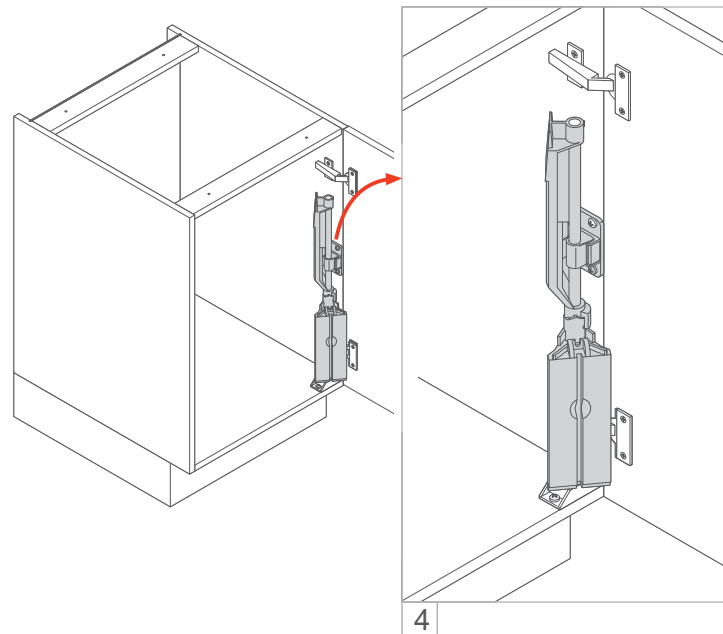

4

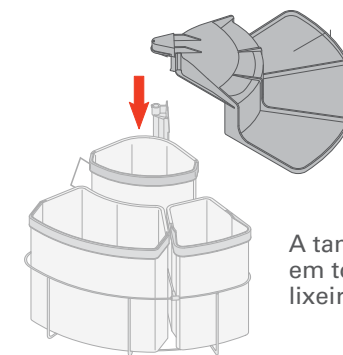
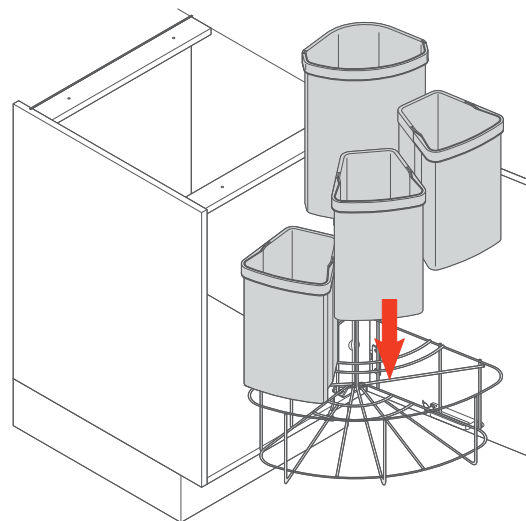

A tampa giratória está presente em todas as composições das lixeiras.

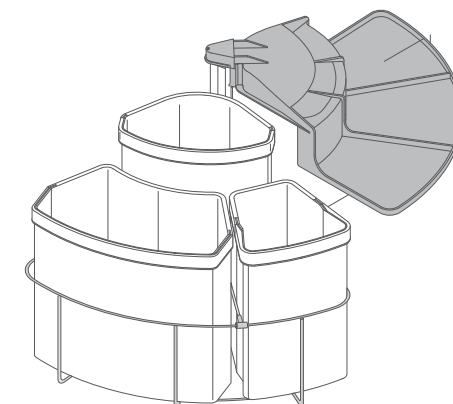

Posicionamento do cesto

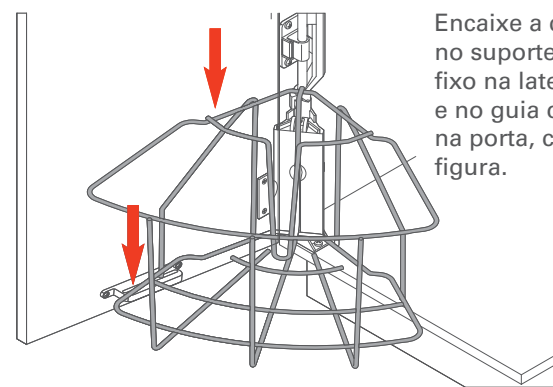

Encaixe a cesto aramado no suporte do cesto, fixo na lateral do móvel e no guia do cesto, fixo na porta, como ilustra a figura.

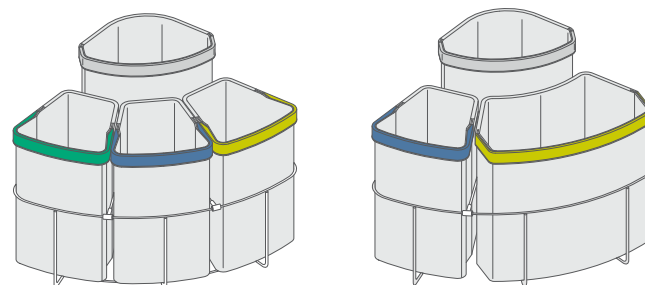

Os cestos possui cores nas alças para facilitar a separação do lixo



ATENÇÃO

Capacidade em litros das lixeiras

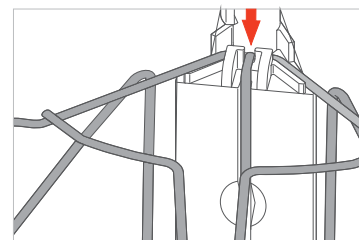

Detalhe do encaixe do cesto aramado no suporte do cesto

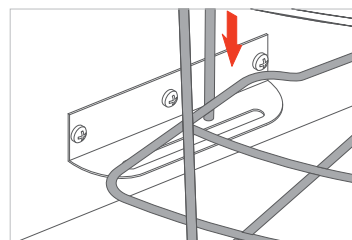

Detalhe do encaixe do cesto aramado no guia do cesto



ATENÇÃO

A tampa levanta automaticamente com a abertura da porta.

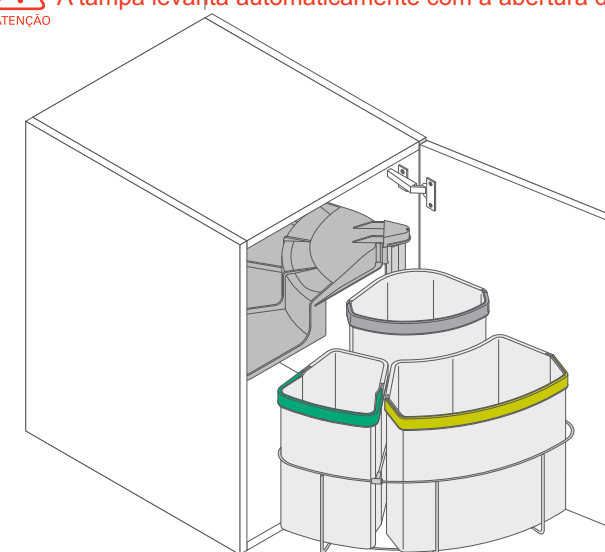

Em seguida encaixar os recipientes plásticos no aramado.



ATENÇÃO



ATENÇÃO

O nosso serviço de assistência técnica está a disposição para quaisquer esclarecimentos que se façam necessários. Nos reservamos o direito de modificar as especificações técnicas sem aviso prévio.